

TAYLOR REGIONAL HOSPITAL HEALTHLINK

Volume 9, Issue 1 • Fall 2006

New Pediatric Wing Dedicated

Renovations funded by 2005 H.O.P.E. Gala proceeds

Taylor Regional Hospital held a dedication ceremony for the new pediatric wing on October 10, 2006. Work has been completed on the \$1.5 million renovated wing and includes nine private rooms for the youngest of patients at TRH. These rooms all have private baths and the latest in modern technology and convenience to ensure that their stay is as comfortable as possible.



Above and top right are views of a patient room and hallway in the new wing.

“This project is the culmination of many months of planning and anticipation,” says Jane Wheatley, CEO of Taylor Regional Hospital. “The funds from the 2005 H.O.P.E. Gala were directed towards the completion of this wing. We are grateful for the generosity of all

donors from our first major fundraising effort and they are now able to see their efforts rewarded.” Sponsors from the first gala who chose to “Name a Room” by donating \$25,000 were Citizens Bank, Wehr Constructors and Luckett & Farley Architects & Engineers.

The H.O.P.E. sponsor of \$10,000 was Community Trust Bank, and the Charity sponsor of \$5,000 was Jewish Hospital & St. Mary’s HealthCare. Faith sponsors of \$2,500 were Campbellville University, Cox Interior and James Medical Equipment.

Construction began in early Spring 2006 with expected opening day being October 16, 2006. Luckett & Farley were the architects on this project, with Wehr Constructors as the construction company. ♥



At right, the new Pediatric Wing is officially opened at a ribbon cutting.



Hospital Embarks on Parking Lot Expansion

Taylor Regional Hospital has begun a \$500,000 parking lot expansion which will entail the addition of almost 100 new parking spaces when completed. According to Luke Williams, Plant Operations Director at TRH, the number of handicap spaces will more than double and the total number of new spaces will be exactly 84. "This project is something that will benefit everyone in our region who receives services here. It will be much easier and safer to enter and exit the parking lot when the project is finished," says Williams.

The front of the hospital will receive an entire facelift, not just an expanded parking lot, according to hospital CEO, Jane Wheatley. "In addition to the much needed spaces, we are also revising the flow of traffic in and out of the hospital. There will be a main entrance and exit which will be more conducive to the heavy volume of traffic at peak times of the day," says Ms. Wheatley. "In addition, we will be installing a new more modern sign which will become a landmark for Taylor Regional Hospital while allowing us to better communicate with our community."

The architect for this project is Luckett & Farley, with Wehr Constructors as the Construction Managers. The expected date of completion is mid-November 2006.

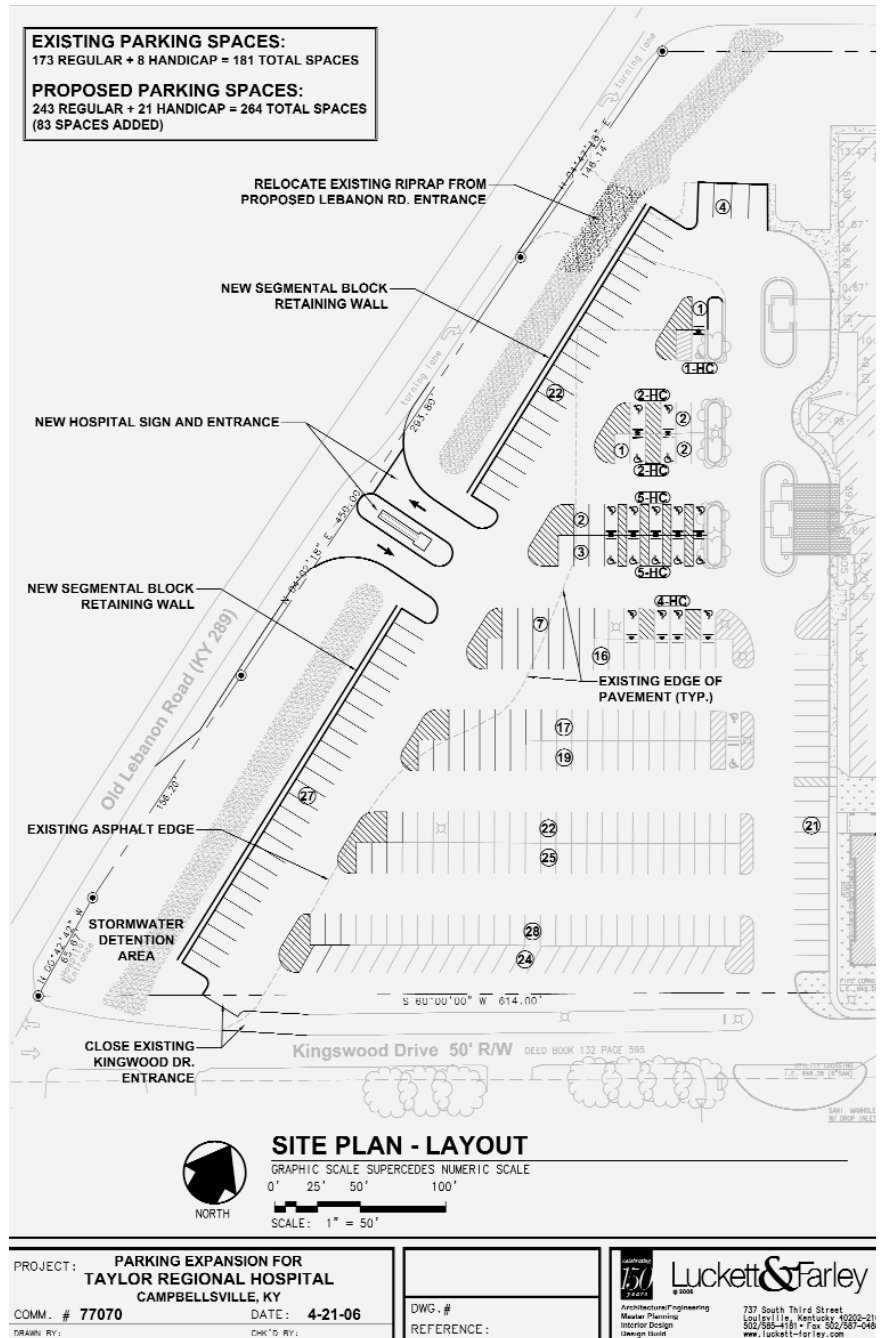

Tripling of Endoscopy Suites Improves Department's Wait Times

An expansion in the surgery department is making room for two additional endoscopy suites, which will bring our total number of suites to three. This will allow the operating rooms to be open for more serious cases and should better allow for more convenient scheduling and wait times for these procedures. These new suites will be located in the former location of the emergency department near the front of the hospital.

Community

2006 H.O.P.E. Gala "Tropical Retreat" a Success

Dining, dancing cap fun evening; funds raised will help upkeep of transport van

Guests attending the 2006 H.O.P.E. Gala "Tropical Retreat" on September 16 enjoyed a romantic tropical evening of dining, dancing to the Trendells, and a live and silent auction.

The event, held at the Holiday Inn Express in Campbellsville, was a fundraising success as well, raising over \$44,000 for the operation and maintenance of a 14-passenger van to be used to transport patients for cancer treatments and other medical tests and treatments at Taylor Regional Hospital.

"We are extremely pleased with the results of this year's gala," says Jane Wheatley, CEO, "It was an excellent evening that was enjoyed by about 250 individuals."

The H.O.P.E. \$10,000 sponsors were Citizens Bank and Community Trust Bank. The Charity \$5,000 sponsor was Jewish Hospital & St. Mary's HealthCare. The Faith \$2,500 sponsors were Campbellsville Apparel, Campbellsville University, Cox Interior, James Graham Brown Cancer Center at Taylor Regional Hospital, Luckett & Farley and Wehr Constructors. Thank you to these sponsors and all who supported this year's Gala! 🍷



Community

Management Staff Provides Service to Community

Taylor Regional Hospital management staff participated in community service projects as part of a two-day leadership institute held on August 24 and 25, 2006. "Several projects were completed as a part of this event," says Jane Wheatley, CEO. "We were proud to have the opportunity to give back to others and contribute to the overall well-being of our community."

Work completed included winterizing the little league fields at Miller Park and Trace Creek, landscaping the welcome signs into Taylor County, and moving the food pantry to its new location. "The Taylor County Ministerial Association really appreciates the help the hospital's management staff gave us," says Michael Goodwin. "We knew we were going to move the food pantry to its new location but also knew we needed many volunteers to accomplish this move. While in the process of planning the move to the new location, I received a phone call from Jay Eastridge, Director of Pharmacy at TRH, asking me if the food pantry could use any help. This assistance could not have arrived at a better time and was such a blessing."

The TRH management staff have been conducting leadership institutes as a part of their overall quality improvement process since 2002. This program focuses on six areas of achievement which include people, service, finance, quality, growth and community. 🍀



Management staff participating in the community service projects posed for a group photo.



**American
Red Cross**

Blood Drives

All blood drives are held from noon to 5:00 p.m.
in the TRH front parking lot.

DATES IN 2007

January 19	May 18	September 14
March 16	July 13	November 16

Taylor Regional Hospital Free Educational Offerings

To register or for additional information, please call the number listed under each session.

Expectant Parents Class

6:00 pm every Tuesday
TRH Meeting Room
Instructor – Jenny Dobson,
RN, CLC, CCE
465-3561, Ext 2231

Diabetes Day

Monday, November 13

9:00 am - Noon
TRH Meeting Room

Taylor Regional Hospital will join with Lake Cumberland District Health Department to have a Diabetes Day in recognition of National Diabetes Month.

If you plan to attend,
please call (270) 789-5862.

Support Groups

Make Today Count (Cancer Support Group)

6:00 pm, 2nd Thursday of every month
TRH Meeting Room

Tattered Tickers (Cardiac Support Group)

6:00 pm, 4th Thursday of every month,
excluding summer months
TRH Meeting Room

Living with Diabetes

5:30 pm, 4th Monday of every month,
excluding summer months
TRH Meeting Room

People

Three New Physicians Join TRH Staff

Dr. George Bodeanu, Pediatrician, has joined the active medical staff at TRH and has opened a medical practice at 125A Kingswood Drive in Campbellsville. Appointments can be made by calling (270) 789-4788. His current office hours are Monday thru Friday, 9:00 am – 5:00 pm.



George Bodeanu, M.D.

Dr. Bodeanu obtained his medical degree from University of Medicine and Pharmacy in Bucharest, Romania. He completed his residency at Tod Children's Hospital in Youngstown, Ohio,

Two new orthopedic surgeons will soon be joining the active medical staff. **Dr. Richard A. Sanders** and **Dr. Aaron S. Tragos** will be joining the TRH team in the upcoming weeks. Dr. Sanders is slated to begin his practice in November 2006 and Dr. Tragos is expected to begin in late Spring 2007.

Dr. Sanders is a board certified orthopedic surgeon who received his medical degree from the University of Louisville and completed his internship and residency programs at the University of California, San Francisco Medical Center. He has completed

fellowships in trauma and burn research, sports medicine and hand surgery. Dr. Sanders has also completed fellowships in Germany and The Netherlands. He most recently comes to TRH from Birmingham, Alabama where he has been in private practice since 1993.



Richard Sanders, M.D.

Dr. Aaron Tragos is a board eligible orthopedic surgeon who received his medical degree from the College of Osteopathic Medicine of The Pacific in Pomona, California and completed his internship program at St. Johns Riverview Hospital in Detroit, Michigan. He completed his residency program at the Bi-County Community Hospital in association with Michigan State University. He has been involved in a private practice focusing on sports medicine and is currently with the department of orthopedics at Downeast Community Hospital in Machias, Maine. ♥



Aaron Tragos D.O.

Congressman Ron Lewis Visits Hospital

Congressman Ron Lewis toured Taylor Regional Hospital during his recent visit to Campbellsville on August 17, 2006. Congressman Lewis was updated on recent construction and new services that have been added at TRH. "We are fortunate to have a Congressman who is so involved and supportive of our community and health care facility," says Jane Wheatley, CEO of Taylor Regional Hospital. ♥

Congressman Lewis is pictured here touring the Health Care Information Department with Jane Wheatley and Lisa Dunnington.



Quality

Taylor Regional Hospital, Laboratory and Home Health Awarded Accreditation from Joint Commission

By demonstrating compliance with the Joint Commission on Accreditation of Healthcare Organization's national standards for health care quality and safety, Taylor Regional Hospital, Laboratory and Home Health have all earned the Joint Commission's Gold Seal of Approval™.

Founded in 1951, the Joint Commission is dedicated to continuously improving the safety and quality of the nation's health care through voluntary accreditation. The Joint Commission's on-site survey of Taylor Regional Hospital occurred in September 2006.

"Above all, the national standards are intended to stimulate continuous, systematic and organization-wide improvement in an organization's performance and the outcomes of care," says Darlene Christiansen, executive director,

Hospital Accreditation Program, Joint Commission. "The community should be proud that Taylor Regional Hospital is focusing on the most challenging goal – to continuously raise quality and safety to higher levels."



Jane Wheatley, CEO, spoke of her pride in a staff whose members ask what needs to be done to be accredited by the Joint Commission. "In addition, they appreciate the educational aspect of the survey and the opportunity to interact with the team of surveyors. We want to thank all of our physicians, team members, auxiliary volunteers, chaplains, board of trustees and community supporters who make us the health care facility of choice in the region."

She called the accreditation "proof of an organization-wide commitment to provide quality care on an ongoing basis." ♥

Service

Let's Talk Health with Taylor Regional Hospital

Tune in to Campbellsville University's TV4 for a new show, "Let's Talk Health with Taylor Regional Hospital," featuring updates on what's happening at TRH, innovative procedures and technology available locally and many more informative programs.

"This program is brought to the community by a joint effort from Campbellsville University and Taylor Regional Hospital and is meant to educate our citizens about their own health care," says Jane Wheatley, CEO of TRH. "We appreciate the opportunity to work with CU to bring this program to fruition."

Stay tuned!! ♥



Tree of Life Donations

Foundation Stones (\$1,000)

- In memory of Mr & Mrs Fletcher Clark and Son, by Clarissa & David Gault
- In memory of Helen & Richard Gault
- In memory of Robert E. & Elizabeth S. Patterson, by Edwin P. & Pat Abell Family
- In memory of Hugh L. & Mabel P. Abell, by Edwin P. & Pat Abell Family
- In memory of Dr. William K. Pennebaker, by Jean, Kirt, Mark & John
- In memory of Floyd T. Hensley, Jr., by Alta A. Hensley
- In honor of Victor Wilson Warren, Mary Beatrice Sprowles Warren, Jeanette Warren Morford, Samuel Glass Morford, J.D. Warren, Barbara Warren, Tommie Brown, Sharon Brown, Marvin Warren, Sheri Warren, Margaret Warder Morford, Donald Warren Morford, and Campbellsville Baptist Church
- In memory of Margie Roberts Wise – Mom
- In memory of Ernest Wise, Sr. – Dad

Acorns (\$500)

- In memory of Ray E. Blevins, General Contractor of the original TCH, 1972, given by Family
- In memory of Garnett & Virginia Rice and Josh & Robert Wells, by Wayne & Kathy Wells
- In memory of Judy Eastridge, wife, mother, grandmother, and friend
- In memory of Robert A. Page, given by friends at Taylor Regional Hospital
- In loving memory of Henry F. Chambers, M.D., given by Campbellsville Rotary Club
- In loving memory of Dr. Henry “Hank” Chambers, from your friends at TRH.
- In memory of William Garland Ball, Sr., 9-19-1933 to 4-3-2005, by his family.
- In loving memory of Earl Mariz, from TRH Team Members and TRH Auxiliary Volunteers

Leaves (\$250)

- Dedicated by Pam Druin, in memory of her parents
- In honor of Earl & Edith Mariz, by children

- In loving memory of Charlene Brockman, for 22 years of service
- In memory of Moss & Ruth Milby, by the children
- In honor of Edgar & Emilene Milby, by Myrna Martin & Grandchildren
- In memory of Jack & Girtie Burton, by Leon & Rose Burton
- In honor of our sons, Kevin & Stuart, dedicated by Helen & Calvin Burris
- In loving memory of Willis Carter, dedicated by JoAnne Carter & Family
- Charlie Shaw, Chief of CTCR, in recognition of service to TRH from 1966-2004
- Morris and Jane Horn
- In memory of our loved one, Logan Malone, sadly missed, the Malone Family
- In memory of our parents, John & Mary Cable, Sue, John, David & Tommy
- In loving memory of Gary E. Whitley, by his family
- In memory of Capt. David O. Dernier, USAF, 1963-2005
- In memory of Paul and Sara Coop, from the Leadership Team at Taylor Regional Hospital
- In memory of Connie Woodrum, from co-workers and friends
- In memory of Marcella Fisher by friend, Garland Cox
- In loving memory of Joan Moss
- In memory of Arnie Judd, In honor of Anita Judd, by co-workers and friends

Financial Information for FY2006 (July 1, 2005 - June 30, 2006)

Charity Care ██████████ \$1,406,427.68

Indigent Care ██████████ \$1,541,342.26

Tax Rebate █████ \$172,329.70

“Walk of Hope” offers lasting tribute, supports hospital



This year’s H.O.P.E. Gala added a new “path” to helping the hospital. A “Walk of Hope” has been initiated in which individuals may purchase a brick to be placed at the hospital in honor or memory of a loved one.

This is a wonderful way to create a lasting tribute to someone special while supporting your local hospital. Just fill out the form at left and return it with your check, made out to Taylor Regional Hospital, to:

“Walk of Hope”
Taylor Regional Hospital
1700 Old Lebanon Road
Campbellsville, KY 42718

Taylor Regional Hospital Walk Of Hope

Pathway Of Brick Is To Honor And
Remember The Ones You Love
And Raise Money For A Good Cause

Bricks Are \$100 Each

For Information Call Michele Dickens
At 270-789-5792

Donator Information

Name _____

Address _____

Phone _____

Brick Engraving Information

Up To 4 Line of 20 Characters Including Spaces

<input type="checkbox"/>	<input type="checkbox"/>	<input type="checkbox"/>	<input type="checkbox"/>	<input type="checkbox"/>	<input type="checkbox"/>	<input type="checkbox"/>	<input type="checkbox"/>	<input type="checkbox"/>	<input type="checkbox"/>	<input type="checkbox"/>	<input type="checkbox"/>	<input type="checkbox"/>	<input type="checkbox"/>	<input type="checkbox"/>	<input type="checkbox"/>	<input type="checkbox"/>	<input type="checkbox"/>	<input type="checkbox"/>	<input type="checkbox"/>
PRINT CLEARLY PLEASE																			
<input type="checkbox"/>	<input type="checkbox"/>	<input type="checkbox"/>	<input type="checkbox"/>	<input type="checkbox"/>	<input type="checkbox"/>	<input type="checkbox"/>	<input type="checkbox"/>	<input type="checkbox"/>	<input type="checkbox"/>	<input type="checkbox"/>	<input type="checkbox"/>	<input type="checkbox"/>	<input type="checkbox"/>	<input type="checkbox"/>	<input type="checkbox"/>	<input type="checkbox"/>	<input type="checkbox"/>	<input type="checkbox"/>	<input type="checkbox"/>
<input type="checkbox"/>	<input type="checkbox"/>	<input type="checkbox"/>	<input type="checkbox"/>	<input type="checkbox"/>	<input type="checkbox"/>	<input type="checkbox"/>	<input type="checkbox"/>	<input type="checkbox"/>	<input type="checkbox"/>	<input type="checkbox"/>	<input type="checkbox"/>	<input type="checkbox"/>	<input type="checkbox"/>	<input type="checkbox"/>	<input type="checkbox"/>	<input type="checkbox"/>	<input type="checkbox"/>	<input type="checkbox"/>	<input type="checkbox"/>
<input type="checkbox"/>	<input type="checkbox"/>	<input type="checkbox"/>	<input type="checkbox"/>	<input type="checkbox"/>	<input type="checkbox"/>	<input type="checkbox"/>	<input type="checkbox"/>	<input type="checkbox"/>	<input type="checkbox"/>	<input type="checkbox"/>	<input type="checkbox"/>	<input type="checkbox"/>	<input type="checkbox"/>	<input type="checkbox"/>	<input type="checkbox"/>	<input type="checkbox"/>	<input type="checkbox"/>	<input type="checkbox"/>	<input type="checkbox"/>

A number of bricks for the “Walk of Hope” have already been contributed, as follows:

- In honor of Gerald Button by David Gault
- In memory of Eddie & Marie Hazelwood by Eddie Hazelwood, Flossie Rowe, William Hazelwood, and Phyllis Mattingly
- In memory of Woodruff & Floy Mitchell by Morris and Jane Horn
- In loving memory of Jesse Ray Callahan by Gloria Callahan
- In honor of George Gaddie by Jane Wheatley, Jaclyn Dabney and Landon Dicken
- In memory of Floyd Phillips by Paul and Tresea Phillips
- In memory of Pearl Phillips by Paul and Tresea Phillips
- In memory of Johnny Harrison by Paul and Tresea Phillips
- In memory of Sara Jane Lester by Linda Dernier, Jane Cook, Kym Stein, Lallie Davis, David Massengale, Janet Dixon, Cindy Rose, and Andrea Settle
- In memory of Ben Tucker by Michele Dickens & Family, Allen Tucker & Family, Steve Tucker & Family and Brian Tucker
- In honor of the 2006 H.O.P.E. Gala “Tropical Retreat” Student Volunteers
- In honor of the 2006 H.O.P.E. Gala “Tropical Retreat” Committee Members